

KOHLER® POWER SYSTEMS



INSTALLATION INSTRUCTIONS

Coolant Fill Relocation Kit PA-225339 for 7CCO/CCOZ-RV/Mobile Generator Sets with Sucker Fans

Use this kit on 7CCO/CCOZ-RV/Mobile inline-radiator generator sets equipped with sucker-type fans. This kit moves the coolant fill closer to the service side of the generator set.



Accidental starting.

Can cause severe injury or death.

Disconnect battery cables before working on generator set (negative lead first and reconnect it last).

Accidental starting can cause severe injury or death. Disconnect battery cables (remove negative lead first and reconnect it last) to disable generator set before working on any equipment connected to generator. The generator set can be started by remote start/stop switch unless this precaution is followed.

⚠ WARNING



Hot coolant and steam.

Can cause severe injury or death.

Before removing pressure cap, stop generator set and allow it to cool. Then loosen pressure cap to relieve pressure.

Hot coolant can cause severe injury or death. Allow engine to cool and release pressure from cooling system before opening pressure cap. To release pressure, cover the pressure cap with a thick cloth; then turn it slowly counterclockwise to the first stop. After pressure has been completely released and the engine has cooled, remove cap. If generator set is equipped with a coolant recovery tank, check coolant level at tank.

INSTALLATION

1. Move START/STOP switch to STOP position. Remove generator set battery cables, negative lead first.
2. Allow unit to cool and release pressure from the cooling system before opening the pressure cap. Save pressure cap.
3. Open the drain petcock and drain just enough coolant until the coolant level reaches the bottom of the upper radiator tank.
4. Remove the two coolant fill screws to remove the coolant fill tube. See Figures 1 and 2 for location. Discard the coolant fill tube. Save the mounting hardware.
5. Remove the two hose clamps on the upper radiator hose. Discard the upper radiator hose. Save the hose clamps.
6. Apply a thin film of Permatex® 2C black gasket sealer or equivalent to the water outlet gasket (229176) and mount at the coolant fill location.
7. Mount the new coolant fill tube (225337) on the gasket.
8. Torque the two screws on the coolant fill tube to 6 ft. lbs. (9 Nm).

9. Install the upper radiator hose (225338) to the coolant fill tube and radiator. Locate the hose clamps 1/4 in. (6 mm) from the end of the hose and tighten.
10. Replace whatever coolant was removed from the coolant fill tube and the upper radiator hose.

NOTE

ENGINE DAMAGE! Failure to bleed air from cooling system may cause overheating and subsequent damage to engine.

NOTE

Special attention should be given when checking proper coolant level. After the coolant has been drained, some time is required before complete refill of the engine water jacket takes place.

11. Replace the pressure cap on the coolant fill tube.
12. Reconnect battery cables, negative lead last.
13. Test run generator for a few minutes to check for leaks. Shut off generator set and allow to cool. Check coolant level to insure that all air is purged from the system. Add coolant as necessary to fill system.

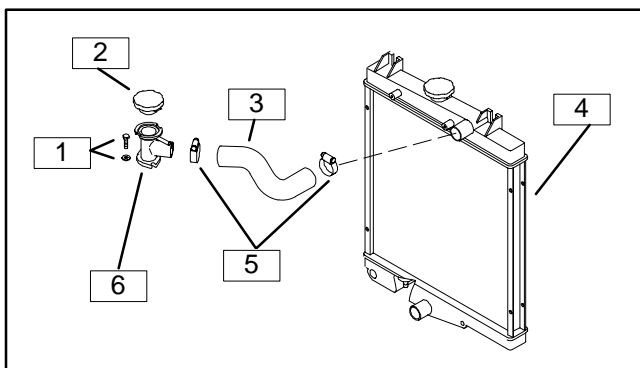

1. Coolant Fill Mounting Hardware
2. Pressure Cap
3. Upper Radiator Hose
4. Radiator
5. Hose Clamps
6. Coolant Fill Tube

Figure 1. Exploded-View Drawing of Coolant Fill

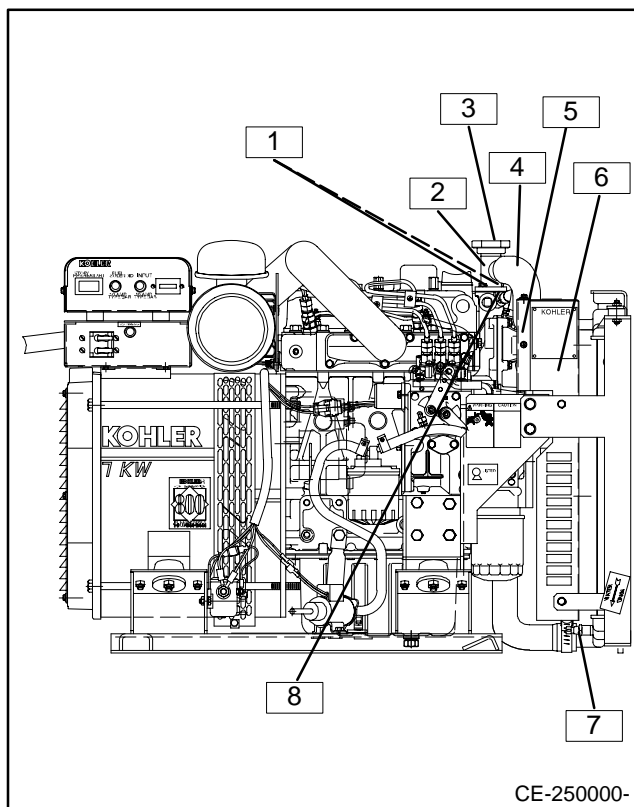

CE-250000-

1. Coolant Fill Mounting Hardware
2. Coolant Fill Tube (225337)
3. Pressure Cap
4. Upper Radiator Hose (225338)
5. Right-Hand Fan Shroud
6. Fan Shroud Cover
7. Drain Petcock
8. Water Outlet Gasket (229176)

Figure 2. Coolant Fill Kit Installation

Parts List

PA-225339		
Qty.	Description	Part Number
1	Tube, Coolant Fill	225337
1	Hose, Upper Radiator	225338
1	Gasket, Water Outlet	229176