



WKT-97 Wheel Kit

For Use On MultiQuip GA-9.7 HZ Portable Generators

Installation Instructions

The following instructions are intended to assist the user in the assembly of the WKT-97 Wheel Kit for use on MultiQuip GA-9.7 HZ Portable Generators. Please read the entire

assembly instructions before assembling wheel kit. Assembly diagrams are provided on the back side of this instruction sheet for your reference.

Tools

- Ratchet set with 1/2 inch socket.
- Crescent Wrench or 1/2 inch open end wrench.

Procedure

1. Position the generator so that access to the bottom **front** of the generator is possible. This may be accomplished by slightly tipping the generator against a wall to gain access to the bottom. **DO NOT** tip the generator more than 90 degrees to avoid engine oil from flooding generator. After generator as been positioned properly, secure generator with blocks to prevent slipping.
2. Install and align axle assembly (P/N 19840) with generator mounting holes as shown in **STEP 1** on the reverse side. Insert hex head screw (P/N 16056) and lock washer (P/N 29091) into opening and tighten securely. Remember to attach axle to the **bottom front** of the generator (below the control panel). Pay close attention to the orientation of the axle mounting brackets, make sure they are positioned on the generator as shown in the **STEP 1** diagram.
3. Slide both wheels (P/N 19850) onto the axle assembly. Secure wheels with flat washer (P/N 8151) and cotter pin (P/N 0183).
4. Set generator in an upright position, and repeat step 1 for access to the bottom **rear** of the generator.
5. Install and align both foot stands (P/N 19835) with generator mounting holes as shown in **STEP 1**. Remember to attach foot stand to the **bottom rear** of generator (below the engine).

Parts

NO.	P/N	PART NAME	QTY.
1	0183	Cotter Pin 1/8 Dia. X 1-1/4 LG	2
2	1404	Screw, HHC 5/16-18 X 3-1/4 #5	8
3	16056	Screw, HHC M10 1.5 X 25	8
4	19701	Clamp Clip (Large)	4
5	19702	Clamp Clip (Small)	4
6	19717	Handle Grip	2
7	19835	Foot Stand	2
8	19839	Handle	2
9	19840	Axle Assembly	1
10	19850	Wheel, (Gleason #19838805)	2
11	5283	Nut, Nyloc 5/16-18	8
12	8151	Washer, Flat 3/4 SAE	2
13	29091	Washer, Lock 10 mm	8

6. Install and align both handles (P/N 19839) with the generator frame as shown in **STEP 2**. Secure both handles to the generator frame using the supplied clamp clips (P/N 19701 and P/N 19702). Place hex head bolt (P/N 1404) through opening in clamp and tighten clamp nut (P/N 5283) securely. Tighten nuts in an even fashion so that the handles do not pull to one side. Remember to pay close attention to the orientation of the clamps (large/small).
7. Push handle grips (P/N 19717) over handle pipe frame as shown in **STEP 2**.
8. Set generator in an upright position when installation is complete.



MULTIQUIP INC.

POST OFFICE BOX 6254 • CARSON, CA 90749
310-537-3700 • 800-421-1244 • FAX: 310-537-3927
E-MAIL: mq@multiquip.com • WWW: multiquip.com

Atlanta • Boise • Dallas • Houston • Newark
Montreal, Canada • Manchester, UK
Rio De Janeiro, Brazil • Guadalajara, Mexico

WKT-97 Wheel Kit

For Use On Multiquip GA-9.7 HZ Portable Generators

MULTIQUIP INC.
 POST OFFICE BOX 6254 • CARSON, CA 90749
 310-537-3700 • 800-421-1244 • FAX: 310-537-3927
 E-MAIL: mq@multiquip.com • WWW: multiquip.com
 Atlanta • Boise • Dallas • Houston • Newark
 Montreal, Canada • Manchester, UK
 Rio De Janeiro • Brazil • Guadalajara, Mexico



STEP 2

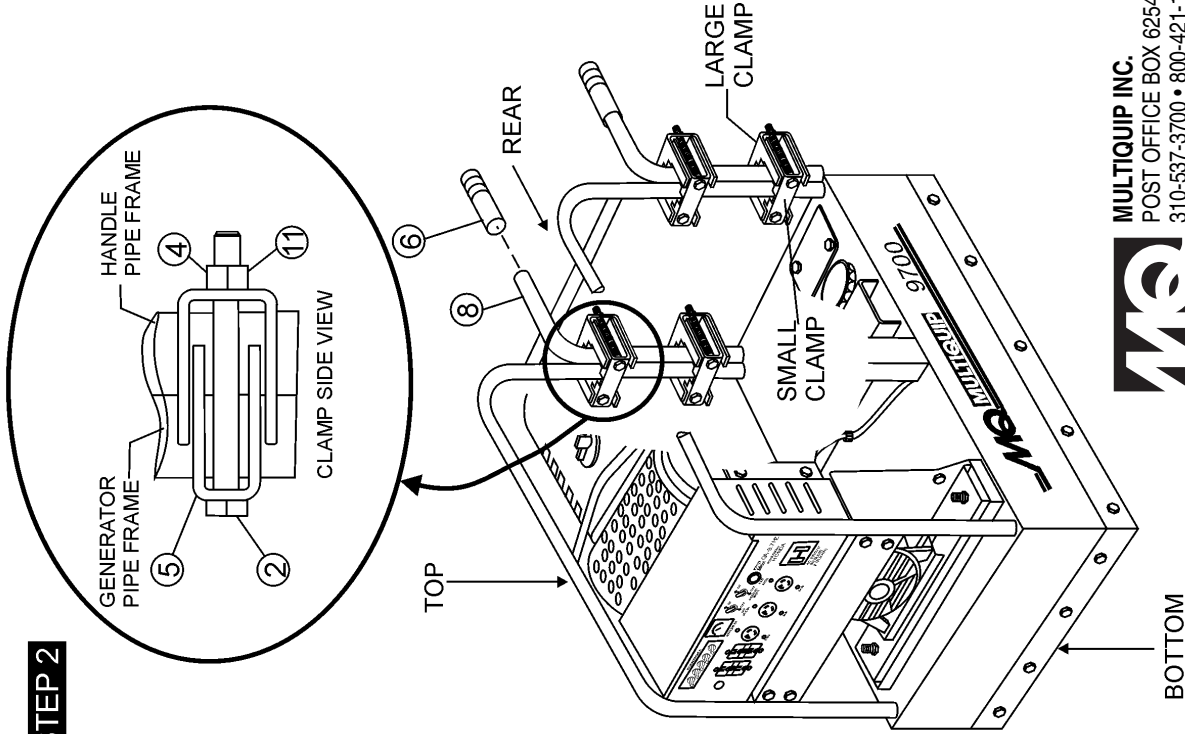

STEP 1

